

Name of premises **THE PARK HOUSE GRAND MINAMIAOYAMA 4-CHOME #306**

Type **Apartment**

Address **4-17-35, Minami-Aoyama, Minato-Ku, Tokyo**

Transportation **8 min. to Omotesando sta. Hanzomon Line
10 min. to Nogizaka Chiyoda Line
19 min. to Roppongi sta. Hibiya Line**

Rent **770,000 yen**

Deposit **2 months**

Key money **1 month**

Room type **3 bed rooms**

Floor space **105.46m²**

Completion **Feb. 2019**

Parking **50,000 yen +Tax**

Appliances **A/C, CATV, BS, CS, dish washer, floor heating**

Availability **Negotiable**

Others **3 years fixed term contract**

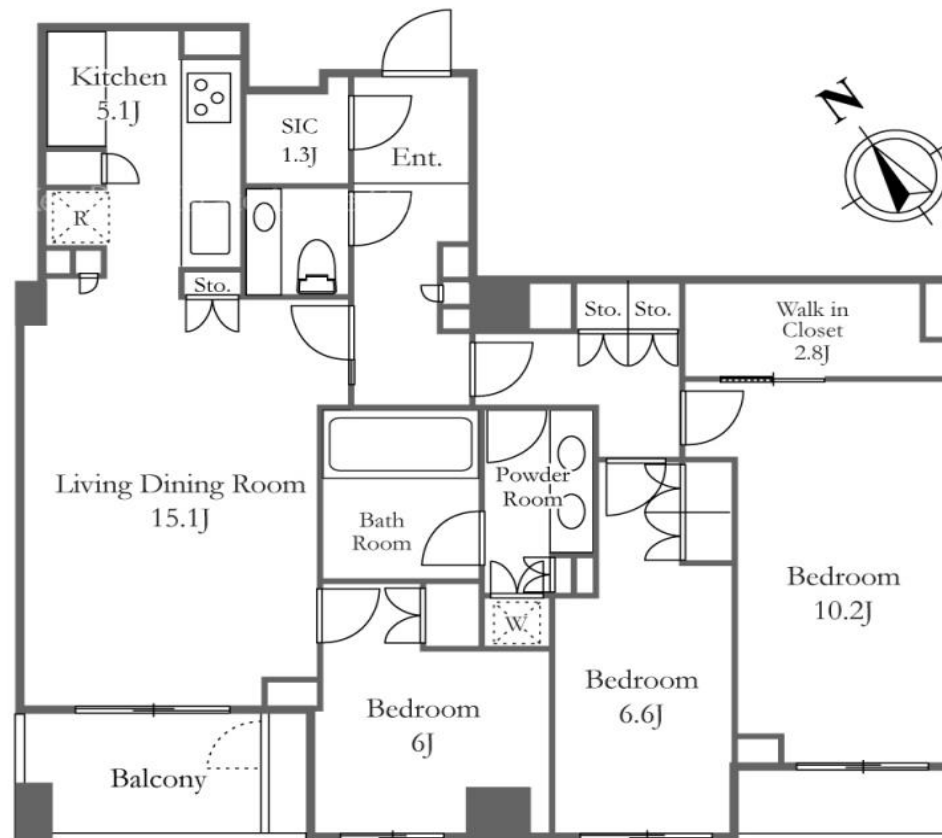

PECS CO., Ltd.

Tokyo Governor License N. (7) 63250

TEL : 03-3423-3330 FAX : 03-3423-0555

Mikawadai Heights 1F, Roppongi 4-3-6, Minato-ku , Tokyo 106-0032